

### 607 Series

- Insulated
- Rugged Perimeter Channel Construction

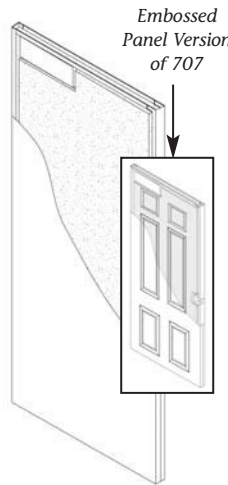

### 707 Series

- Insulated
- Rugged Perimeter Channel Construction
- Versatile/Dependable

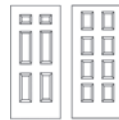

### 727 Series

- Temperature Rise Rated (250°)
- Insulated
- Rugged Perimeter Channel Construction

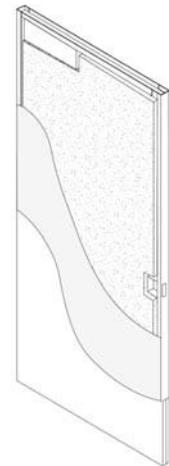

### 737 Series

- Bullet Resistant Level 2
- Insulated
- Rugged Perimeter Channel Construction

NOTE: Closer reinforcements as detailed here are optional.

## Standard Components

	607	707	727	737
<b>Door Thickness</b>	1-3/4" (44)	1-3/8" (35) or 1-3/4" (44)	1-3/4" (44)	1-7/8" (48)
<b>Hinge Rail and Reinforcement</b>	Full Height Channel 14 Gauge Extruded* to 10 Gauge Equivalent	Full Height Channel, 14 Gauge Extruded* to 10 Gauge Equivalent or 12 Gauge Extruded to 7 Gauge Equivalent	Full Height Channel 12 Gauge Extruded† to 7 Gauge Equivalent	Full Height Channel 14 Gauge Extruded* to 10 Gauge Equivalent
<b>Lock Rail</b>	Full Height Channel 16 Gauge	Full Height Channel 14 Gauge	Full Height Channel 14 Gauge	Full Height Channel 14 Gauge
<b>Top Channel</b>	18 Gauge	16 Gauge	12 Gauge	16 Gauge
<b>Bottom Channel</b>	18 Gauge	16 Gauge	16 Gauge	16 Gauge
<b>Core</b>	Insulating Polystyrene	Insulating Polystyrene Std. Isocyanurate Optional	Mineral Core (UL Listed) Fire Door Core	Polystyrene
<b>Insulation</b>	Polystyrene	Polystyrene	Mineral Core (UL Listed) Fire Door Core	Polystyrene
<b>Face Skins</b>	20, 18 Gauge	20, 18, 16, 14 Gauge	18, 16 Gauge	16, 14 Gauge Bullet Resistant Plating
<b>Sizes Available</b>	2068 - 4070	2068 - 50100	2068 - 4080	40100 Maximum
<b>Galvanize Options</b>	—	A-60, G-90	A-60, G-90	A-60, G-90
<b>SDI 100 Level/Model ANSI A250.8</b>	1/1, 2/1	1, 2, 3, 4/1, 2	2, 3/1, 2	3, 4/1, 2
<b>Fire Label Ratings</b>	See Fire Labeled Doors section for complete information.			

\* 14 gauge steel extruded to provide equivalent thread depth of 10 gauge tapped holes.

† 12 gauge steel extruded to provide equivalent thread depth of 7 gauge tapped holes.

## Specifications

### 607 Series Specifications

Doors shall be 607 Series as manufactured by CURRIES, Mason City, Iowa. Doors are to be manufactured of the finest quality 18, 20 (specify gauge) cold rolled stretcher leveled steel. All doors shall be full flush construction 1-3/4" (44) thick. Doors shall be reinforced, stiffened, insulated, and sound deadened with a solid polystyrene foam board permanently bonded to the inside of each face skin. The lock and hinge edge of each door shall be welded with a centered hairline seam the full height of the door (607S). The lock edge shall be reinforced full height by a 16 gauge continuous one piece channel x extruded templating. The hinge edge shall be reinforced full height by a 14 gauge continuous one piece channel, formed and tapped for hinges. Top and bottom of the door shall be closed with 18 gauge channels. Doors are square hinge and lock edge featuring a non-handed design. Doors shall be thoroughly cleaned and receive an iron phosphate treatment prior to receiving one coat of prime paint. Minimum hardware reinforcement shall consist of the following: Closers – Overhead Holders – Rim Panics, 14 gauge channels; Butts and Locks as previously specified herein.

### 707 Series Specifications

Doors shall be 707 Series as manufactured by CURRIES, Mason City, Iowa. Doors are to be manufactured of the finest quality 14, 16, 18, 20 (specify gauge) cold rolled stretcher leveled steel or galvanized steel (specify). All doors shall be full flush construction and either 1-3/4" (44) or 1-3/8" (35) thick. Doors shall be reinforced, stiffened, insulated, and sound deadened with a solid polystyrene foam board permanently bonded to the inside of each face skin. The lock and hinge edge of each door shall be welded with a centered hairline seam the full height of the door (707S) OR both the lock and hinge edge of each door shall be welded, filled and ground smooth (seamless) the full height of the door (707N) OR the lock and hinge edge of each door may have the center seam continuously wire welded the full height of the door, filled and ground smooth (707T). The lock edge shall be reinforced full height by a 14 gauge continuous one piece channel x extruded templating. The hinge edge shall be reinforced full height by a 14 gauge

continuous one piece channel, formed and tapped for hinges. Top and bottom of the door shall be closed with 16 gauge channels. Doors shall have beveled 1/8" (3) in 2" (51) lock edge and square hinge edge. Doors shall be thoroughly cleaned and receive an iron phosphate treatment prior to receiving one coat of prime paint. Minimum hardware reinforcement shall consist of the following: Closers – Overhead Holders – Rim Panics, 14 gauge channels; Butts and Locks as previously specified herein. Floor Closers and Pivots – 7 gauge x template requirements.

### 727 Series Specifications

Doors shall be 727 Series as manufactured by CURRIES, Mason City, Iowa. Doors are 250 degree or 450 degree temperature rise listed products for the first 30 minutes of a fire test. Doors are to be manufactured of the finest quality 16, 18, (specify gauge) cold rolled stretcher leveled steel or galvanized steel (specify). All doors shall be full flush construction 1-3/4" (44) thick. Doors shall be reinforced, stiffened, insulated, and sound deadened with a solid UL listed mineral core board permanently bonded to the inside of each face skin. The lock and hinge edge of each door shall be welded with a centered hairline seam the full height of the door (727S) OR both the lock and hinge edge of each door shall be welded, filled and ground smooth (seamless) the full height of the door (727N) OR the lock and hinge edge of each door may have the center seam continuously wire welded the full height of the door, filled and ground smooth (727T). The lock edge shall be reinforced full height by a 14 gauge continuous one piece channel x extruded templating. The hinge edge shall be reinforced full height by a 12 gauge continuous one piece channel, formed and tapped for hinges. Top of the door is closed with a 12 gauge channel and bottom of the door shall be closed with a 16 gauge channel. Doors shall have beveled 1/8" (3) in 2" (51) lock edge and square hinge edge. Doors shall be thoroughly cleaned and receive an iron phosphate treatment prior to receiving one coat of prime paint. Minimum hardware reinforcement shall consist of the following: Closers – Overhead Holders – Rim Panics, 14 gauge channels; Butts and Locks as previously specified herein. Floor Closers and Pivots – 7 gauge x template requirements.

### 737 Series Specifications

Doors shall be 737 Series as manufactured by CURRIES, Mason City, Iowa. Doors are to be manufactured of the finest quality 14, 16, (specify gauge) cold rolled stretcher leveled steel or galvanized steel (specify). All doors shall be full flush construction and 1-7/8" (48) thick. Doors shall be reinforced, stiffened, insulated, and sound deadened with a solid polystyrene foam board permanently bonded to the inside of each face skin. Integral armor plating inside of the door shall provide bullet resistive properties in accordance to UL Level 2, HPSA listing. The lock and hinge edge of each door shall be welded with a centered hairline seam the full height of the door (737S) OR both the lock and hinge edge of each door shall be welded, filled and ground smooth (seamless) the full height of the door (737N) OR the lock and hinge edge of each door may have the center seam continuously wire welded the full height of the door, filled and ground smooth (737T). The lock edge shall be reinforced full height by a 14 gauge continuous one piece channel x extruded templating. The hinge edge shall be reinforced full height by a 14 gauge continuous one piece channel, formed and tapped for hinges. Top and bottom of the door shall be closed with 16 gauge channels. Doors shall have beveled 1/8" (3) in 2" (51) lock edge and square hinge edge. Doors shall be thoroughly cleaned and receive an iron phosphate treatment prior to receiving one coat of prime paint. Minimum hardware reinforcement shall consist of the following: Closers – Overhead Holders – Rim Panics, 14 gauge channels; Butts and Locks as previously specified herein. Floor Closers and Pivots – 7 gauge x template requirements.

NOTE: CURRIES bullet resistive frames must be used with these doors.