

Product Description

H-Series is Fleming's 16 gage paintable galvanized, 1-3/4" (44.4mm) thick, fully welded, vertically stiffened door for use in commercial, industrial and institutional settings. They are rated for standard, medium, heavy and extra-heavy duty applications. The H-Series line is available for up to 3 hour fire rated applications in sizes to 4'0" x 10'0" (1250 x 3050mm) singles and 8'0" x 10'0" (2450 x 3050mm) standard or double egress pairs.

Standard Sizes and Hardware Locations

Non-standard sizes to suit specific project requirements are also available. Refer to TDS G03 through G06 for detailed information of hinge and strike locations.

All metric values are shown in millimeters (mm) unless indicated otherwise. Imperial and metric values may not be equal.

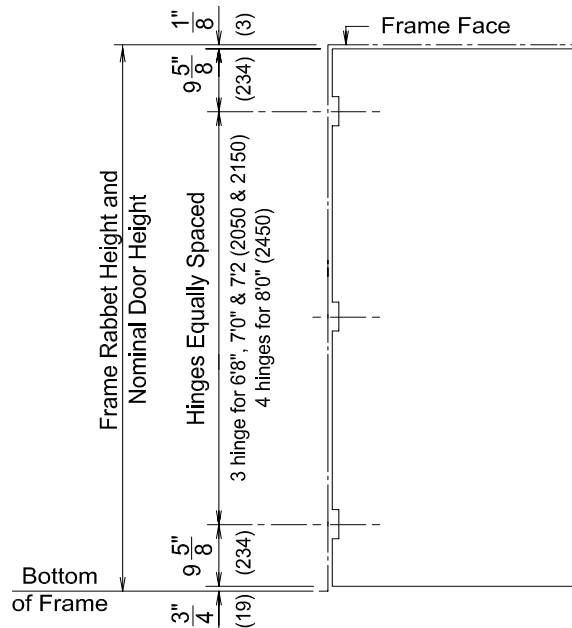

Standard Nominal Door Sizes	
Nominal Door Heights	Nominal Door Widths
6'8" 2050mm	2'0" 600mm
	2'2" 700mm
	2'4" 700mm
7'0" 2150mm	2'6" 800mm
	2'8" 800mm
7'2" 2150mm	2'10" 900mm
	3'0" 900mm
	3'4" 1000mm
8'0" 2450mm	3'6" 1100mm
	3'8" 1100mm
	4'0" 1200mm

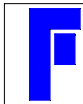

Fleming

Steel Doors & Frames

A United Dominion Company

ARCHITECTURAL
MANUAL

TECHNICAL
DATA SHEET

H-SERIES DOORS

Topic Number : D03

Sheet Number : 2

Date Issued : May '00

Product Features

All H-Series Doors

- Face sheets and all components manufactured from paintable galvanneal steel
- 20 gage continuous vertical interlocking stiffeners at 6" 9150 on center, spot welded to each face sheet at 6" (150 on center with voids between stiffeners filled with loose batt type fiberglass insulation)
- Longitudinal edges continuously welded full height of door, filled and ground smooth with no visible edge seams
- Lock and hinge edges beveled 1/8" in 2" (3 in 50)

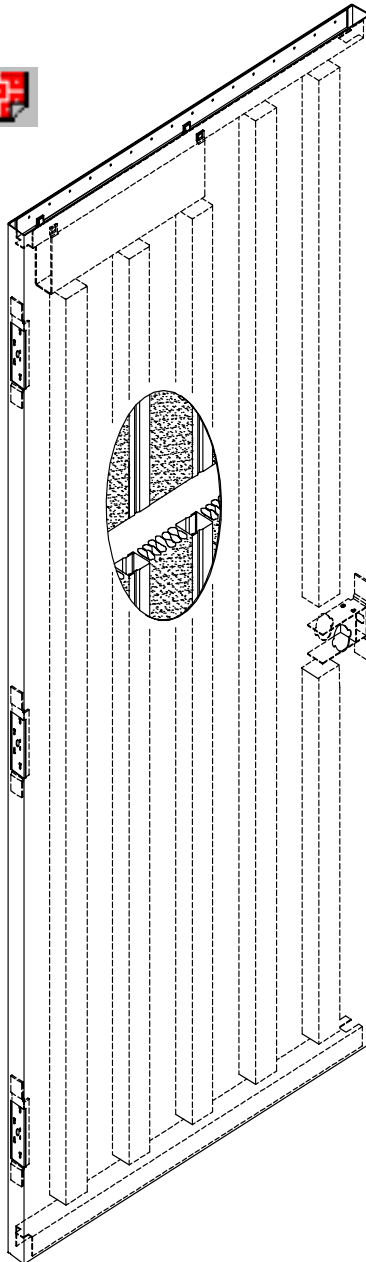

Top Channel and Closer Reinforcing

- Projection welded 1-1/2" (38) extra deep, 16 gage end channels top and bottom with integral 14 gage, 4-1/2" (114) deep x 15" (380) long closer reinforcing channel at top

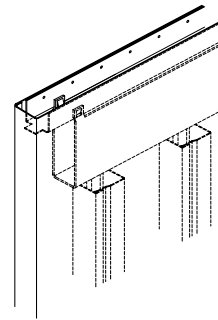

Standard Hinge Reinforcing

- Projection welded 10 gage High Frequency Reinforcing at all hinge cutouts
- Hinge reinforcing dimpled to convert from standard to heavy weight

Cylindrical Lock Preparation

- 12 gage cylindrical lock reinforcing (161), face and edge cutouts for ANSI A115.2 - 2-3/4" (69.9) backset

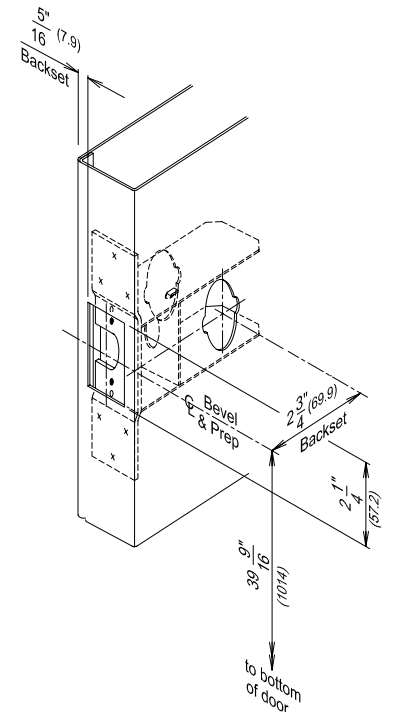
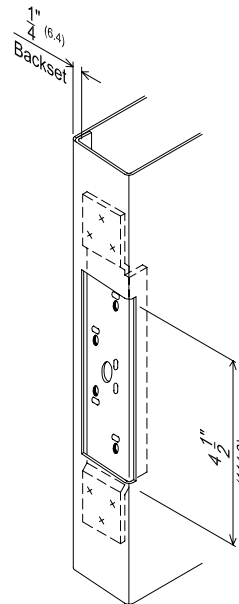

Options
Door Types

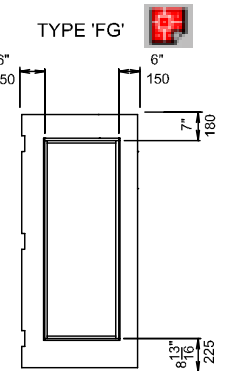
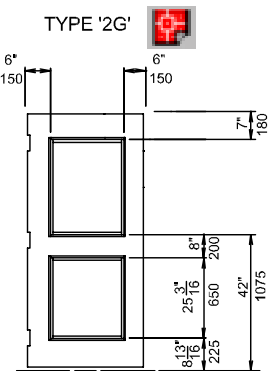
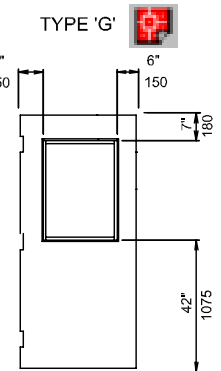
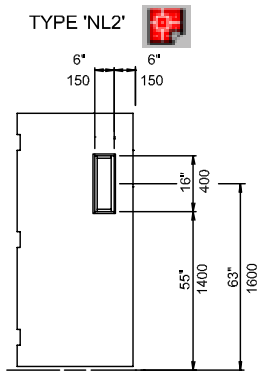
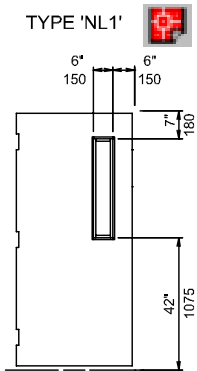
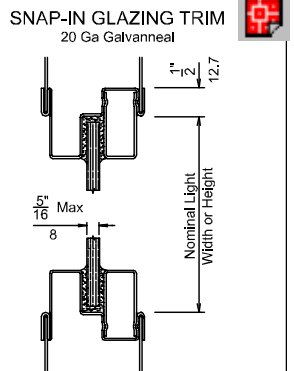
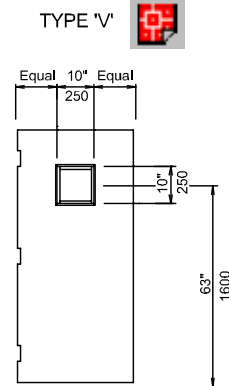
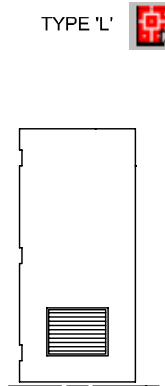
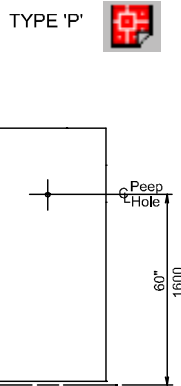
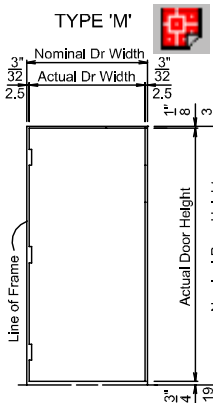

Optional Head Details

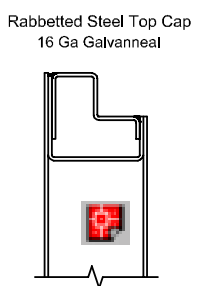
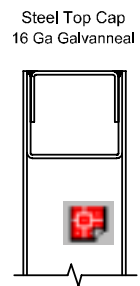
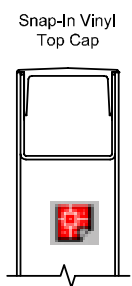
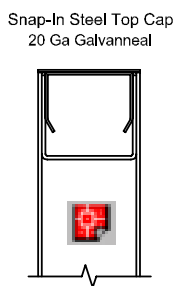

Optional Sill Details

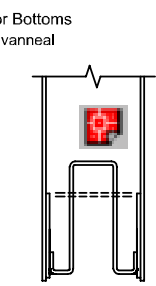
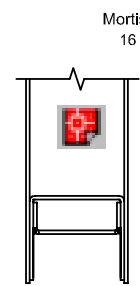
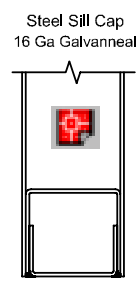

Optional Edge and Meeting Stile Details

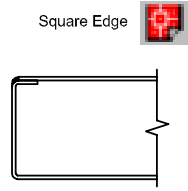

Flat Bar Astragal
12 Ga Galvanneal

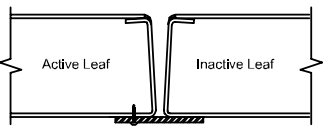

'Z' Astragal
14 Ga Galvanneal

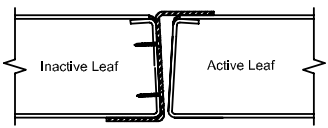

Security 'Z' Astragal
14 Ga Galvanneal

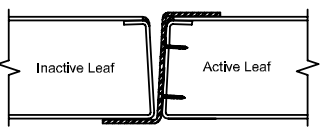

Labeled and Non-Labeled Double Egress
Pair Meeting Edge

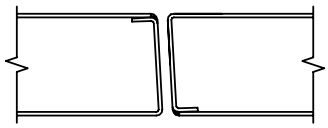

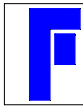

Options (Continued)

Mortise Lock Edge Preparation

- Projection welded 16 gage mortise lock reinforcing (86ED), edge and optional face cutouts for ANSI A115.1

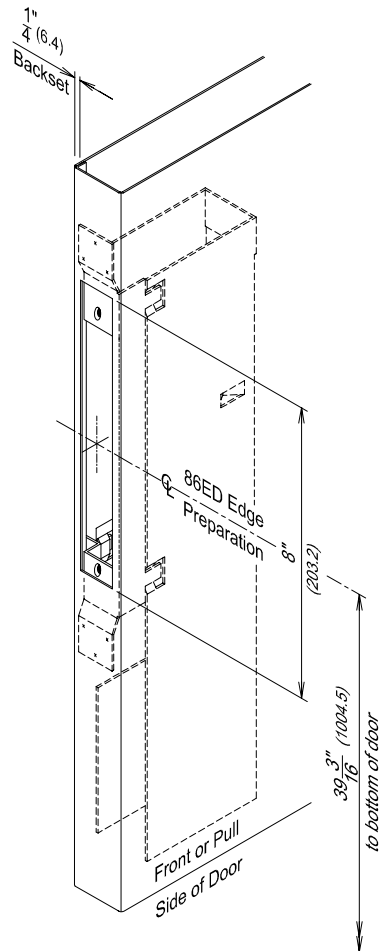

Strike Preparations

- ASA strike (ANSI A115.1-2) (shown) or ASANL strike, projection welded 12 gage reinforcing
- Small ASANL deadbolt strike (ANSI A115.3) at 48" (1220mm) from bottom of frame centerline, projection welded 14 gage reinforcing

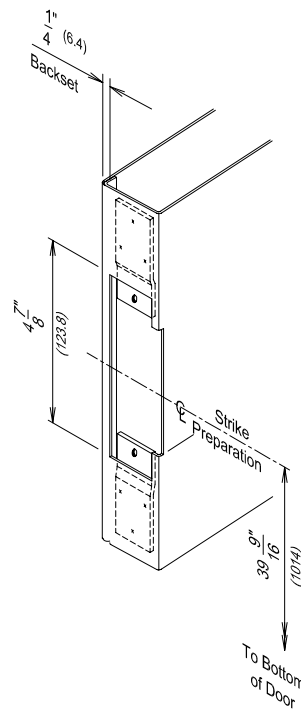

Flush Bolt Preparation

- ASA edge preparation with projection welded 12 gage reinforcing, top and bottom of door preparation with 10 gage tack welded reinforcing to suit ANSI A115.4

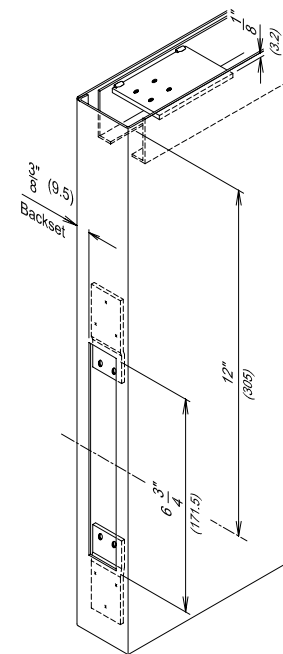

In addition to the typical options above, Fleming offers the following to fully customize H-Series doors to suit project or opening specific requirements:

- 12 [1-7/8" (47.6mm) thick] or 14 gage galvaneal face sheets
- 12 [1-7/8" (47.6mm) thick], 14 or 16 gage G90 galvanized face sheets
- Double egress, double acting, or dutch doors
- Non-standard imperial or metric (SI) nominal widths and heights
- Non-standard thickness: 2" (51) or 2-1/4" (57)
- Non-standard hinge, strike or lock preparations, locations, back-sets and reinforcing
- Reinforcing, edge and face preparations for fire or panic exit devices (rim, mortise, surface or concealed vertical rod)
- Concealed closer or holder preparations and reinforcing
- Preparations for mail slots, door viewers or mono-rails
- Radius or bullnosed edges
- Man-door preparation
- Lead lining

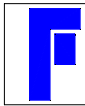

Fleming

Steel Doors & Frames

A United Dominion Company

ARCHITECTURAL
MANUAL

TECHNICAL
DATA SHEET

H-SERIES DOORS

Topic
Number : D03

Sheet
Number : 5

Date
Issued : May '00

Specifications

- 1) Doors shall be H16-Series as manufactured by Fleming.
- 2) Doors shall be fabricated from tension leveled steel to ASTM A924, galvanized to ASTM A653, coating designation A40 (ZF120), known commercially as paintable galvalume.
- 3) Doors shall be flush type, 1-3/4" (44.4mm) thick, with provision for glazed and / or louvered openings as scheduled.
- 4) Doors shall be internally reinforced with 20 gage continuous interlocking steel stiffeners at 6" (150mm) on center, securely welded to each face sheet at 6" (150mm) on center, with voids between stiffeners filled and sound deadened with 1.5 pcf (24kg/m³) loose batt type fiberglass material.
- 5) Longitudinal edges shall be continuously welded full height of door, filled and ground smooth, with no visible seams.
- 6) Doors shall be beveled 1/8" in 2" (3 in 50mm) on both lock and hinge edges.
- 7) Top and bottom of doors shall be provided with projection welded, inverted 16 gage end channels.
- 8) Doors shall be blanked, reinforced, drilled and tapped for fully templated mortised hardware or reinforced only for surface hardware.
- 9) Hinge reinforcing shall be 10 gage steel, high frequency type for templated 4-1/2" (114.3) hinges, convertible from standard to heavy weight.
- 10) Cylindrical lock, ASA strike and flush bolt reinforcing shall be 12 gage minimum.
- 11) Mortise lock and surface mounted hardware reinforcing shall be 16 gage minimum.
- 12) Doors shall be provided with integral 14 gage steel closer reinforcing channel at top of door.
- 13) Exterior doors shall be provided with flush snap-in PVC top caps.
- 14) On exposed surfaces where zinc has been removed during fabrication, doors shall receive a factory applied touch-up primer.
- 15) Contractor responsible for installation shall remove all wraps or covers upon delivery at building site, store on planks or dunnage in a dry location in a vertical position, space with blocking to permit air circulation between them and cover to protect from all damage.
- 16) Install doors in accordance with NAAMM-HMMA 840, "Installation Guide for Commercial Steel Doors and Frames" and for fire rated product, NFPA 80.
- 17) Prior to site touch-up, exposed surfaces of galvalume steel to be finish painted with latex paints shall be cleaned with soap and water. When alkyd finish paints are specified, turpentine or paint thinners shall be used.
- 18) Exposed surfaces which have been scratched or otherwise marred during shipping, handling or installation shall be touched-up with a rust inhibitive primer.
- 19) Finish paint in accordance with Section 09900.