

Product Description

DW-Series is Fleming's standard 16 or 18 gage paintable galvaneal steel, commercial, knocked-down slip-on, drywall profile, punch mitered frame. This Series is designed for installation in steel or wood stud partitions after the application of the drywall. It is available for up to 1-1/2 hour fire rated applications in sizes to 3'6" x 7'2" (1100 x 2200mm) or 3'0" x 8'0" (950 x 2450mm) singles and 7'0" x 7'2" (2150 x 2200mm) pairs. Installation instructions for DW-Series frames are covered on [TDS G10](#).

Standard Sizes and Hardware Locations

Non-standard sizes to suit specific project requirements are also available. Refer to TDS G03 through G06 for detailed information of hinge and strike locations.

- This Series is available for 3 distinct applications : DW-16 (or 18)-4 Series for 1-3/4" (44mm) thick doors
- : DW-18-8 Series for 1-3/8" (35mm) thick doors
- : CODW-16 Series for cased open profile frames

All metric values are shown in millimeters (mm) unless indicated otherwise. Imperial and metric values may not be equal.

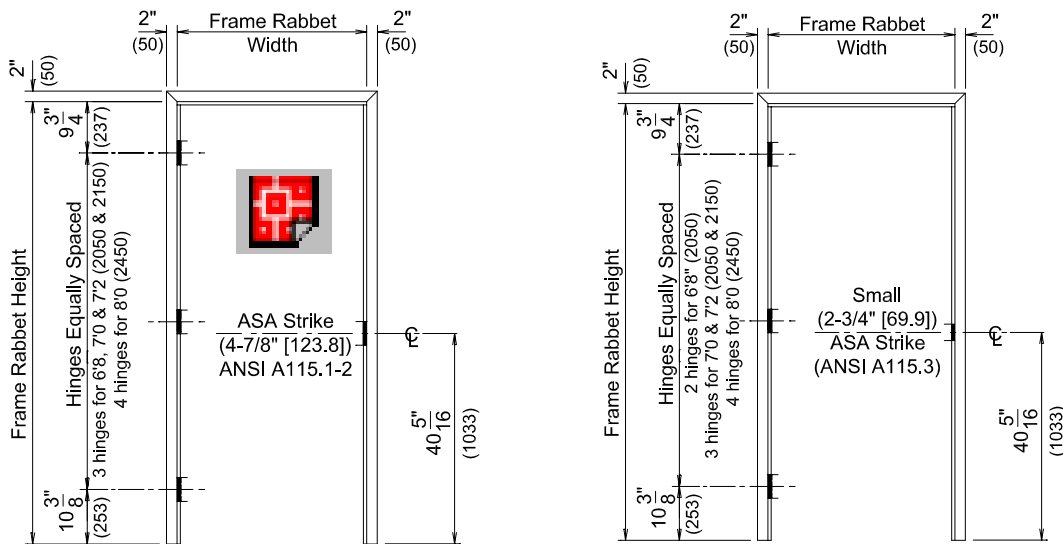

Frames for 1-3/4" (44) thick doors

Frames for 1-3/8" (35) thick doors

Standard Frame Rabbet Sizes				
Frame Rabbet Heights	Frame Rabbet Widths			
	Singles		Pairs	
6'8" 2050mm	2'0"	600mm	4'0"	1200mm
	2'2"	700mm	4'8"	1400mm
	2'4"			
7'0" 2150mm	2'6"	800mm	5'0"	1600mm
	2'8"		5'4"	
7'2" 2150mm	2'10"	900mm	6'0"	1800mm
	3'0"		6'4"	
	3'4"	1000mm	6'8"	2000mm
8'0" 2450mm	3'6"	1100mm	7'0"	2200mm
	3'8"		7'4"	
	4'0"	1200mm	8'0"	2400mm

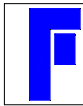

Fleming

Steel Doors & Frames
A United Dominion Company

ARCHITECTURAL
MANUAL

TECHNICAL
DATA SHEET

DW-SERIES FRAMES

Topic Number : F02

Sheet Number : 2

Date Issued : May '00

Standard Profiles

DW - 16 (or 18) - 4 Series
1-3/4" (44mm) Thick
Door Profile

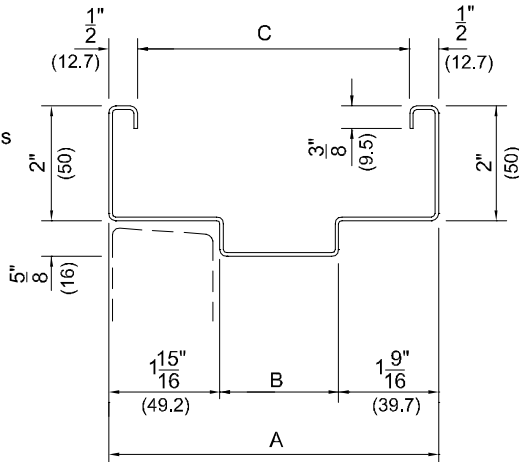

DW - 18 - 8 Series
1-3/8" (35mm) Thick
Door Profile

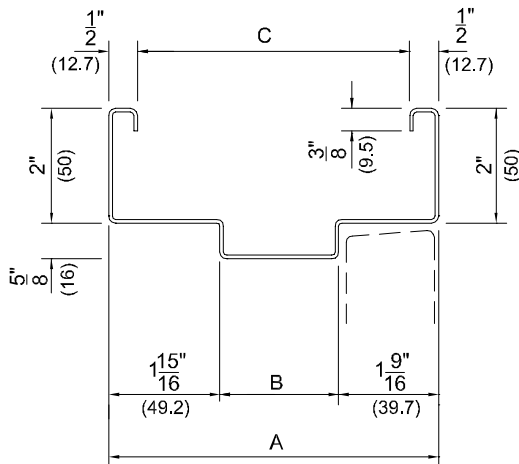

CODW - 16 Series
Cased Open Profile

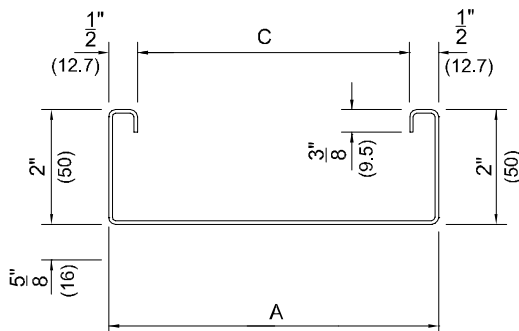

A Jamb Depth	B Soffit	C Throat
4 1/2 (114)	1" (25.4)	3 1/2 (88.9)
4 3/4 (121)	1 1/4 (31.8)	3 3/4 (95.3)
5 5/8 (143)	2 1/8 (54)	4 5/8 (117.5)
5 7/8 (149)	2 3/8 (60.3)	4 7/8 (123.8)
6 1/4 (159)	2 3/4 (69.9)	5 1/4 (133.4)
6 5/8 (168)	3 1/8 (79.4)	5 5/8 (142.9)
7 1/8 (181)	3 5/8 (92.1)	6 1/8 (155.6)
7 3/4 (197)	4 1/4 (108)	6 3/4 (171.5)
8 1/4 (210)	4 3/4 (120.7)	7 1/4 (184.2)
9 1/2 (241)	6" (152.4)	8 1/2 (215.9)

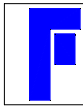

Fleming

Steel Doors & Frames

A United Dominion Company

ARCHITECTURAL
MANUAL

TECHNICAL
DATA SHEET

DW-SERIES FRAMES

Topic Number : F02

Sheet Number : 3

Date Issued : May '00

Product Features

All DW-Series Frames

- Components manufactured from paintable galvanized steel
- Jamb and heads machine punched for tight, true fitting corner miters
- All jambs provided with 2 projection welded 20 gage corner clips

Typical Head

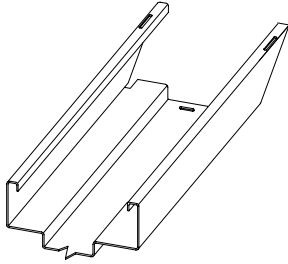

Assembled KD-DW Corner

- Corner clip tabs at head returns bent over in field

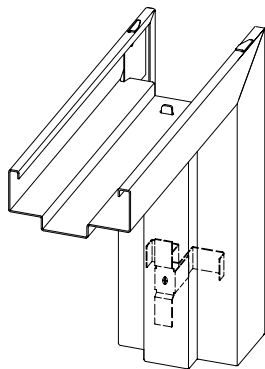

Typical Hinge Jamb

- Projection welded 10 gage reinforcing at all cutouts
- 4-1/2" (114.3) high frequency type, dimpled to convert from standard to heavy weight hinge for 1-3/4" (44) doors
- 3-1/2" (88.9) templated hinge reinforcing standard for 1-3/8" (35) doors
- All 1-3/4" (44) door hinge jambs provided with embossed UL fire label

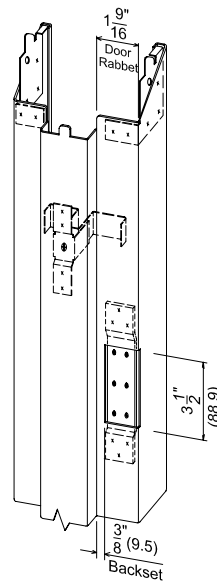
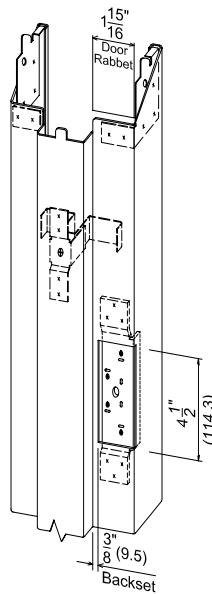

Typical Strike Jamb

- Projection welded 16 gage ASA strike reinforcing (ANSI A115.1-2) with 1" (25) deep integral dust box standard for 1-3/4" (44) doors
- Projection welded 14 gage small ASA strike reinforcing (ANSI A115.3) standard for 1-3/8" (35) doors
- Machine punched for door silencers

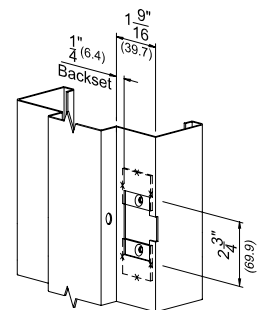
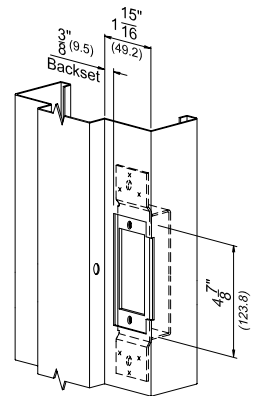

Anchors

Compression Anchor

- Provided at top of each hinge and strike jamb

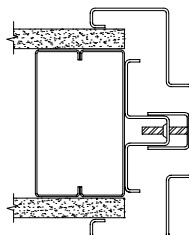
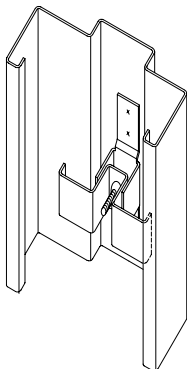

Face Dimpled Base Anchor

- Bottom of each hinge and strike jamb pierced and dimpled in both faces (standard drywall screws provided by installer)

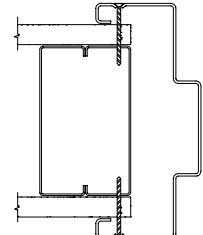
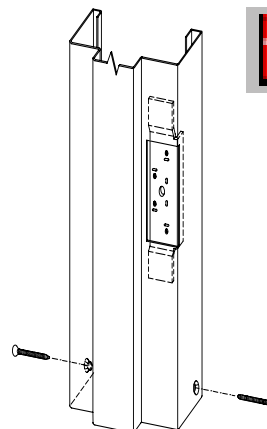

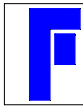

Fleming

Steel Doors & Frames

A United Dominion Company

ARCHITECTURAL
MANUAL

TECHNICAL
DATA SHEET

DW-SERIES FRAMES

Topic Number : F02

Sheet Number :

Date Issued : May '00

Options

Surface Closer Reinforcing

- 12 gage galvaneal steel

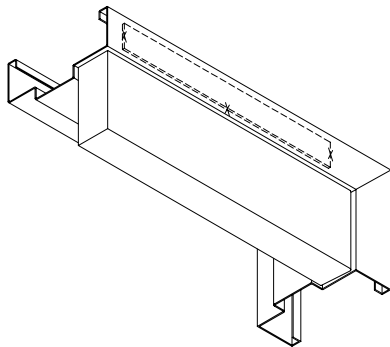

Parallel Arm Closer Reinforcing

- 12 gage galvaneal steel

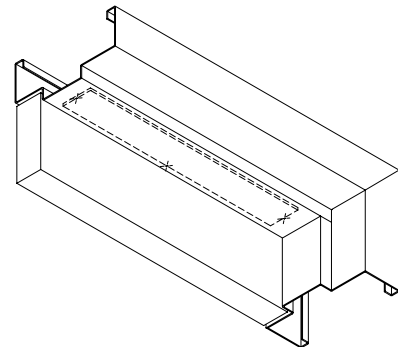

Reversible Flush Bolt Strike

- ANSI A115.4
- 16 gage chromated galvaneal steel

Small ASA N/L (Deadbolt) Strike

- ANSI A115.3
- 14 gage galvaneal steel

Snap-In Base Anchors

- 16 gage galvaneal steel
- Provided in lieu of face dimpled base anchor when specified

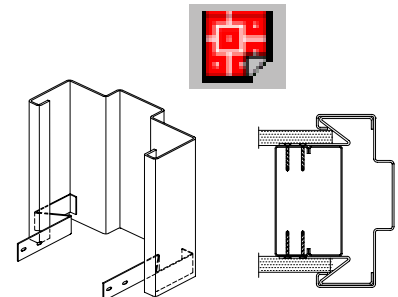
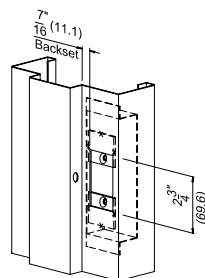
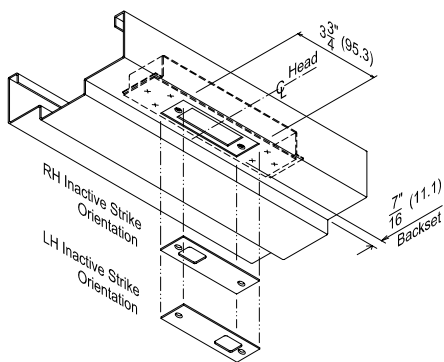

In addition to the typical options above, Fleming offers the following to customize DW-Series frame product to suit project or opening specific requirements:

- Non-standard imperial or metric (SI) nominal widths, heights and jamb depths
- Non-standard hinge or strike locations, back-sets, weights and reinforcing thickness
- Non-standard hinge and strike preparations
- Head preparations for surface, concealed or semi-concealed closers or holders, flush bolt strikes, vertical rod exit device strikes, door position switches and magnetic locks
- Sanitary bases

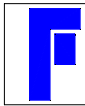

Specifications

- 1) Frames shall be as manufactured by Fleming, of the Series indicated:
 - a) DW-16-4 Series (16 gage for 1-3/4" (44mm) thick doors)
 - b) DW-18-4 Series (18 gage for 1-3/4" (44mm) thick doors)
 - c) DW-18-8 Series (18 gage for 1-3/8" (35mm) thick doors)
 - d) CODW-16 Series (16 gage cased open profile)
- 2) Frame components shall be straight and uniform throughout their lengths, fabricated from tension leveled steel to ASTM A924, galvanized to ASTM A653, coating designation A40 (ZF120), known commercially as paintable galvaneal.
- 3) Corner joints shall be accurately mitered and tightly fitted with integral door stops butted.
- 4) Frame construction shall be knocked-down slip-on and shipped unassembled. Corners shall be provided with 20 gage steel reinforcements and tabs which securely interlock mechanically with factory prepared heads.
- 5) All reinforcements shall be projection, spot or arc welded securely to frame
- 6) Frames shall be blanked, reinforced, drilled and tapped for fully templated mortised hardware or reinforced only for surface hardware.
- 7)
 - a) Frames prepared for 1-3/4" (44) doors shall be provided with 10 gage steel high frequency type hinge reinforcing for templated 4-1/2" (114.3) hinges, convertible from standard to heavy weight, with 22 gage steel dust box at each cutout.
 - b) Frames prepared for 1-3/8" (35) doors shall be provided with 10 gage steel hinge reinforcing for templated 3-1/2" (88.9) standard weight hinges.
- 8)
 - a) Frames prepared for 1-3/4" (44) doors shall be provided with 16 gage steel strike reinforcing to suit ASA (ANSI A115.1-2) strike with 1" deep integral dust box
 - b) Frames prepared for 1-3/8" (35) doors shall be provided with 14 gage steel strike reinforcing to suit small ASA (ANSI A115.3) strike
- 9) Flush bolt strikes (ANSI A115.4), when specified, shall be reversible type, 16 gage chromated steel
- 10) When specified, reinforcements for surface mounted hardware, concealed closers and holders shall be 12 gage steel.
- 11) Each jamb shall be provided with 1 adjustable compression anchor located 5" (125) from the intersection of the jamb and head door stops.
- 12) Each jamb shall be punched and dimpled 3/4" (19) from the bottom to receive countersunk drywall screws for secure anchorage to the drywall and floor runner.
[Alternate: Each jamb shall be provided with 2 snap-in drywall base anchors for installation in each jamb face to secure frame to the drywall and floor runner.]
- 13) For fire labeled frames only:
 - a) Each strike jamb shall be provided with 2 snap-in anchors, to be installed in the jamb faces, immediately above or below the strike reinforcing.
 - b) Each head for fire labeled pairs shall be provided with 2 snap-in anchors, to be installed in the head faces at the center of the rabbet width.
- 14) Each door opening shall be prepared for GJ-64 or equivalent single stud door silencers, 3 per strike jamb for single door openings, 2 per head for pairs.
- 15) On exposed surfaces where zinc has been removed during fabrication, frames shall receive a factory applied touch-up primer.
- 16) Contractor responsible for installation shall remove all wraps or covers upon delivery at building site, store on planks or dunnage in a dry location in a vertical position, space with blocking to permit air circulation between them and cover to protect from all damage.
- 17) Set frames plumb, square, aligned, without twist at correct elevation in accordance with Fleming TDS G10, NAAMM-HMMA 840, "Installation Guide for Commercial Steel Doors and Frames" and for fire rated product, NFPA 80.
- 18) Prior to site touch-up, exposed surfaces of galvaneal steel to be finish painted with latex paints shall be cleaned with soap and water. When alkyd finish paints are specified, turpentine or paint thinners shall be used.
- 19) Exposed surfaces which have been scratched or otherwise marred during shipping, handling or installation shall be touched-up with a rust inhibitive primer.
- 20) Finish paint in accordance with Section 09900.